

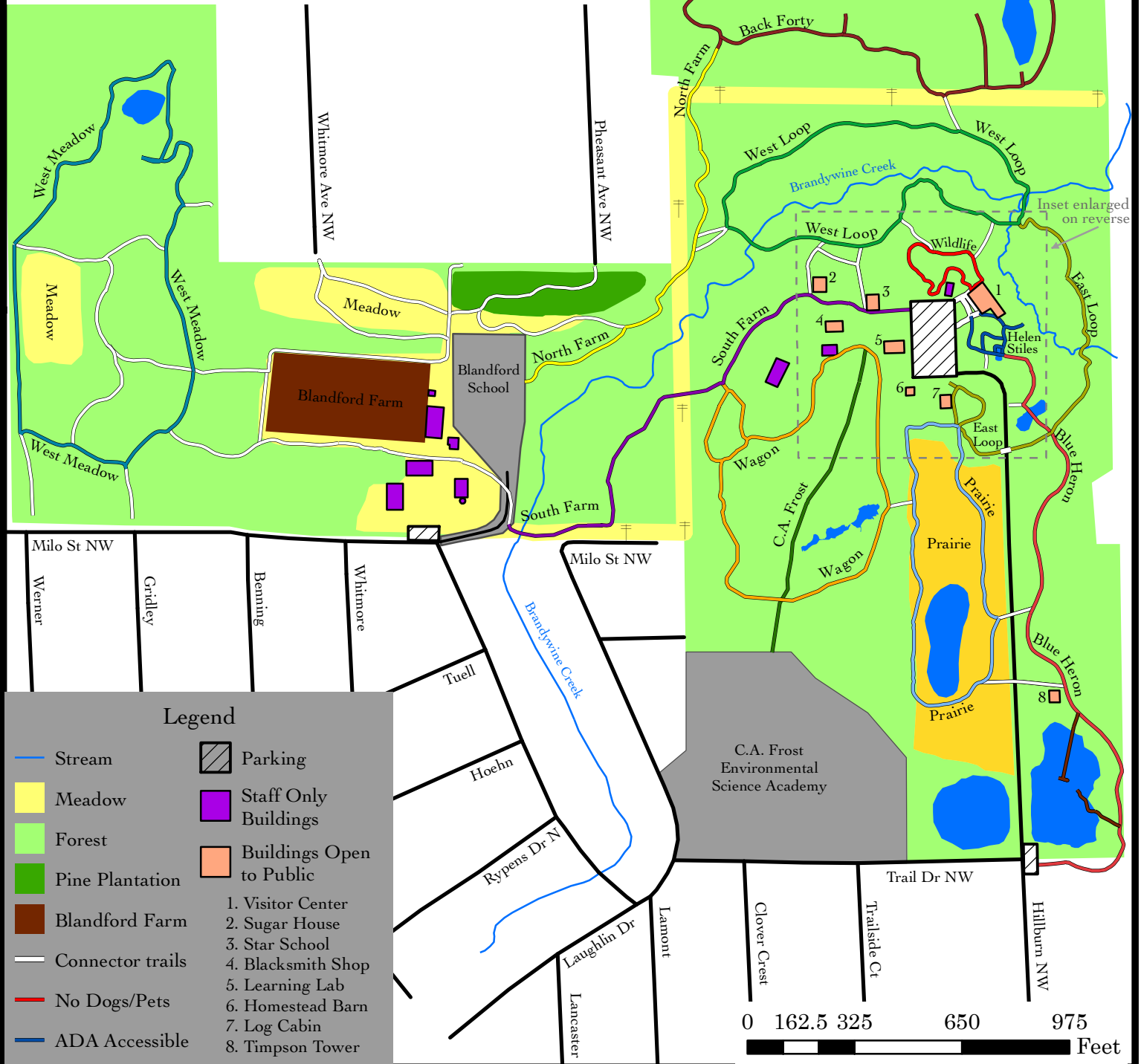

# BLANDFORD | nature center

1715 Hillburn NW Grand Rapids, MI 49504  
(616) 735-6240 blandfordnaturecenter.org

- \*The Visitor Center is open M-F 9-5 and Sat. 12-5
- \*Please check in or pay at the Visitor Center
- \*Admission is free for members, \$3 for non-members
- \*Please be courteous and yield to our school programs
- \*Dogs are allowed on trails, except the Wildlife Trail, and must be kept on a leash at all times.



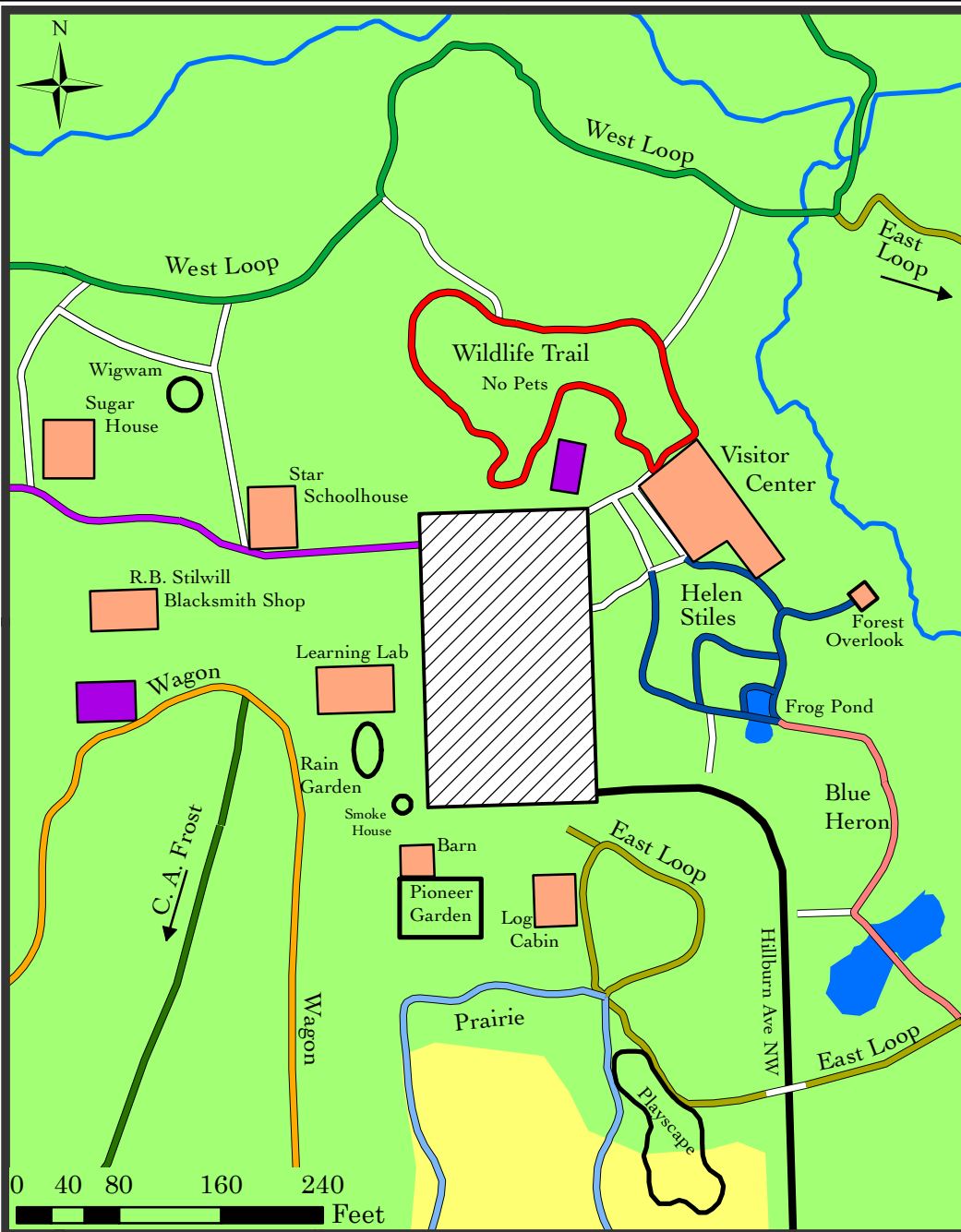

Legend	
	Stream
	Prairie
	Wetlands
	Forest
	Staff Only Buildings
	Buildings Open to Public
	Connector trails
	No Dogs/Pets
	ADA Accessible

### Trail Descriptions

- Easy
- Medium
- Difficult

Trail distances are approximate and trails less than .1 miles are not marked. Trail difficulties vary seasonally.



Wildlife: Winds through a display of our resident animals  
 Helen Stiles: A flat, short, mostly paved trail in front of the Center, ADA accessible.  
 C.A. Frost: A short, straight trail leading to C.A. Frost Elementary  
 Wagon (.5 miles): Wide dirt loop meandering through various vegetation types



North Farm (.2 miles): Connects Farm to the Back Forty, slightly hilly  
 South Farm (.3 miles): A long, flat trail connecting the Farm to the Center  
 Blue Heron (.4 miles): Mostly flat trail connecting Hillburn and the Center  
 West Meadow (.6 miles): A flat trail accessible from Milo St



East Loop (.25 miles): A very hilly trail with a lot of steps  
 West Loop (.45 miles): Very hilly and has multiple bridges and steps  
 Back Forty (.7 miles): The longest trail, mostly flat, but slightly bumpy